

20 FENCHURCH ST.
LONDON

ENTIRE 6TH FLOOR
HIGH-QUALITY PLUG & PLAY OFFICE
15,327 SQ FT

HIGH QUALITY PLUG & PLAY OFFICE, WITHIN A LANDMARK BUILDING

AVAILABLE ON FLEXIBLE
LEASING TERMS



SUMMARY SPECIFICATION



Plug and play



Excellent views
and natural light



Low energy fan coil
air-conditioning

BREEAM®

BREEAM
Excellent

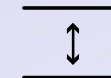

Floor to ceiling
glazing



Roof top garden/
restaurant/event
space



Occupational
density 1:8 m²



Bike storage

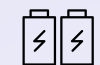

Dual power
supply



Showers &
Changing facilities

FLOOR 6

15,284 SQ FT
1,420 SQ M

Desks: 186
Meeting Rooms: 9
Break Out Areas: 2

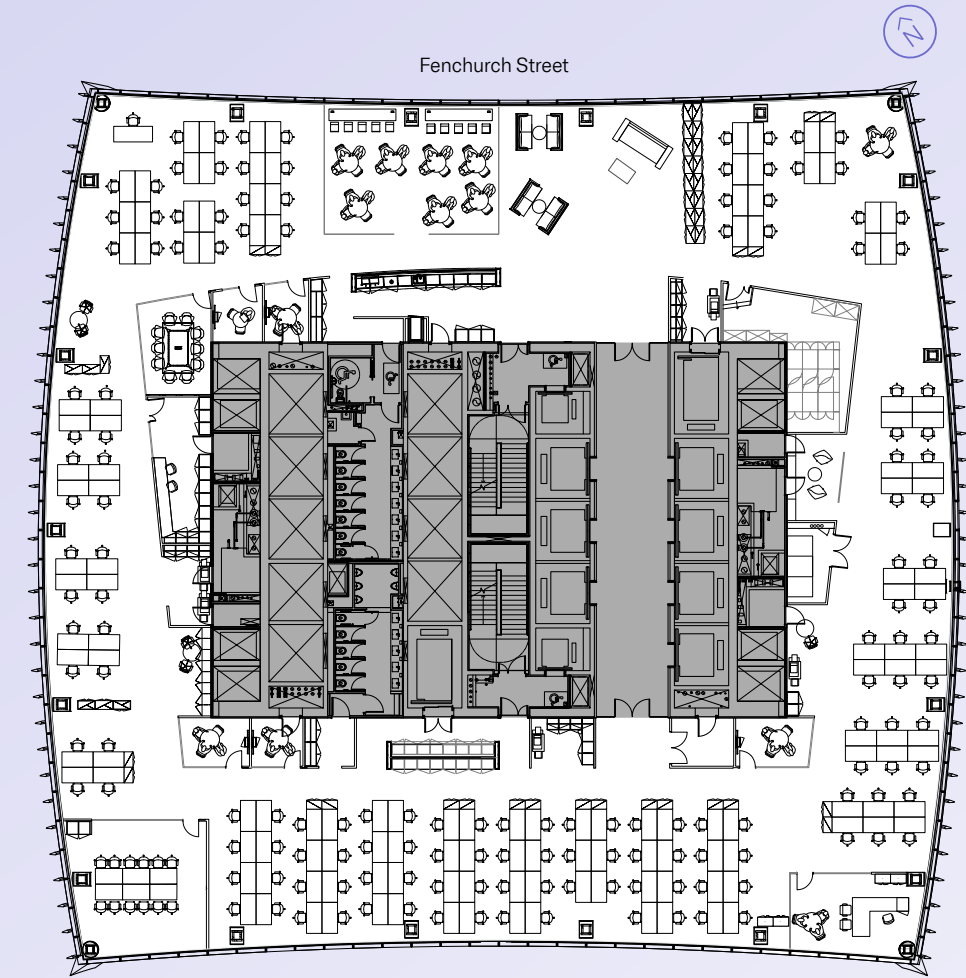

KEY

Office Core



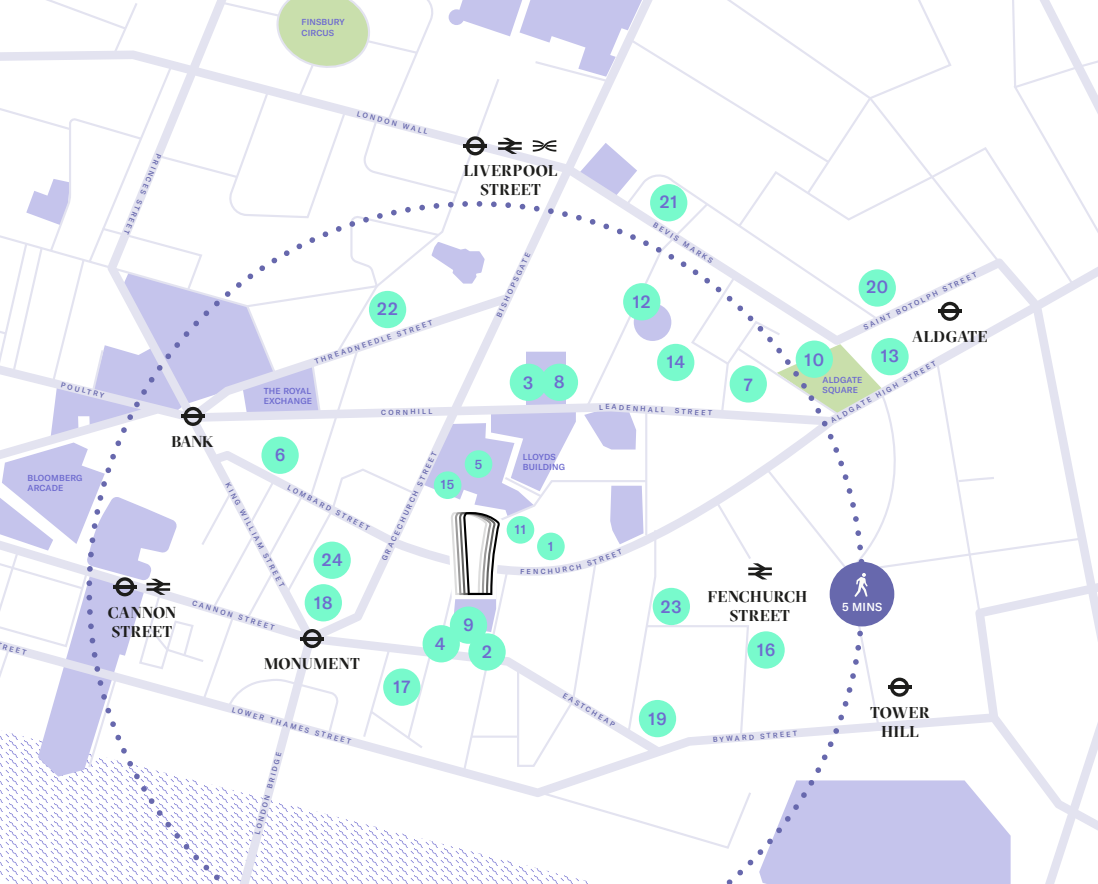

DINING

1. 14 Hills
2. Darwin Brasserie
3. Bob Bob Cité
4. Blacklock
5. Chamberlains
6. Hispania



CAFÉS

7. Association Coffee
8. Black Sheep
9. Joe & The Juice
10. Kahaila Aldgate
11. Curators Coffee
12. Notes Coffee Roasters



BARS

13. Jin Bo Law
14. Swingers
15. Planet of the Grapes
16. Savage Garden LDN
17. Eastcheap Records
18. The Folly



WELLNESS

19. Third Space City
20. Pure Gym
21. 1 Rebel
22. Virgin Active
23. Pure Spa & Beauty
24. Boom Cycle



NEWTON
PERKINS



Nick Russell-Smith
nrs@newtonperkins.com
M: +44 (0)7918 588 107

Florence Elliott
florence.elliott@eu.jll.com
M: +44 (0)7720 070 425

Jonathan Beilin
jb@newtonperkins.com
M: +44 (0)7976 392 016

Nick Lines
nick.lines@eu.jll.com
M: +44 (0)7817 586 971

Roger Weaver
rew@newtonperkins.com
M: +44 (0)7976 634 189

TWENTYFEN.CO.UK

Newton Perkins and JLL gives notice that these particulars are set out as a general outline only for the guidance of intending Purchasers or Lessees and do not constitute any part of an offer or contract. Details are given without any responsibility and any intending Purchasers, Lessees or Third Party should not rely on them as statements or representations of fact, but must satisfy themselves by inspection or otherwise as to the correctness of each of them. No person employed or engaged by Newton Perkins and JLL has any authority to make any representation or warranty whatsoever in relation to this property. January 2022. Designed by Studio 185. studio185.london | 174